

KIT PRODUCT TECHNICAL DATASHEET

SET BR21/354

Brushless 

Intensive use 

Digital Encoder 



Composition SET BR21/354

CODE	DESCRIPTION	QTY
BR21/351	Electromechanical underground motor BRUSHLESS low voltage, super intensive use, with native encoder on-board, irreversible, ideal for swing gates with leaf up to 4.5 m. Standard version with short 2 m cable.	2
FU101	Foundation box and lid in hot-galvanised steel.	2
RL650	Release system for underground motor with standard lever.	2
KIT EDGE1/20	Complete electronic kit with 36V EDGE1/BOX digital controller for 2 BRUSHLESS motors. With 2-channel radio receiver installed on board.	1
	Composition KIT EDGE1/20	
	EDGE1/BOX Digital control 36V for 2 BRUSHLESS motor, in plastic box. With 2-channel radio receiver installed on board.	1
	SYNUS/2 Dual code transmitter (modality fixed code or rolling code), 433,92 MHz, 2 channels, with copy function.	2
	R90/F4ES Pair of external photocells synchronized 24V AC/DC, up to a maximum of 4 pairs of photocells.	1
	FIFTHY/24 LED flashing light 24V with integrated antenna.	1
	R99/C/001 Signboard "Automatic Opening".	1

PRODUCT TECHNICAL SPECIFICATIONS

Power line supply	230V AC - 50 Hz
Stand-by consumption	0,5W
Motor power supply	36V
Power rating	200W
Frequency of use	Intensive use
Torque	50 - 300N m

Operating temperature	-20+55°C
Protection level	IP67
Reductor Type	Irreversible
Manoeuvre speed	1,2 Rpm
Opening time	19-29 s
Limit switch	Mechanical stoppers
Recommended digital controllers	-
Encoder	Digital native encoder SENSORLESS 48 PPR
Maximun opening	105° (optional 125° - 360°)
Power supply cable length	2m
Bearing on main shaft	Standard
Operating cycles per day (opening/closing - 24 hours no stop)	1300
Maximum dimension product in mm (L x W x H)	345 x 224 x 144
Product weight packed (Kg)	70,6

PRODUCT DIMENSIONS AND PREPARING FOR INSTALLATION

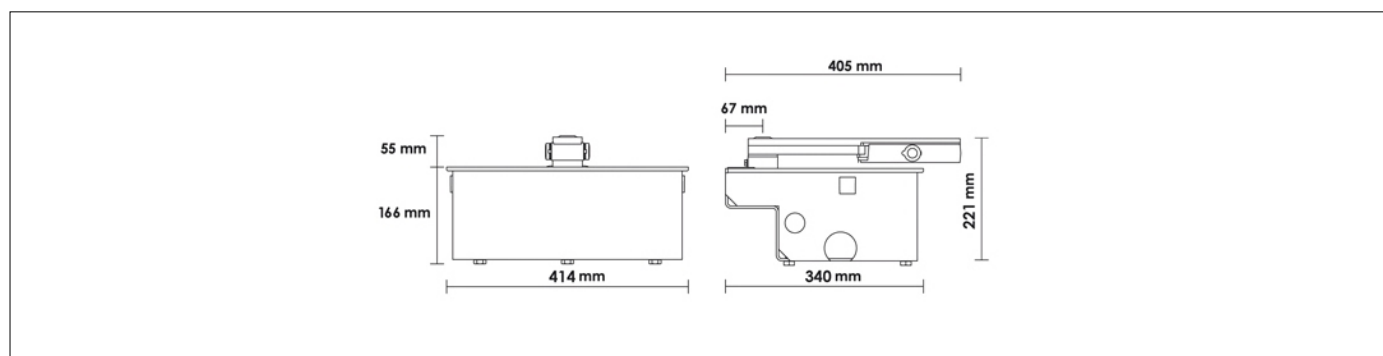

DIMENSIONS

PRODUCT PREPARING FOR INSTALLATION

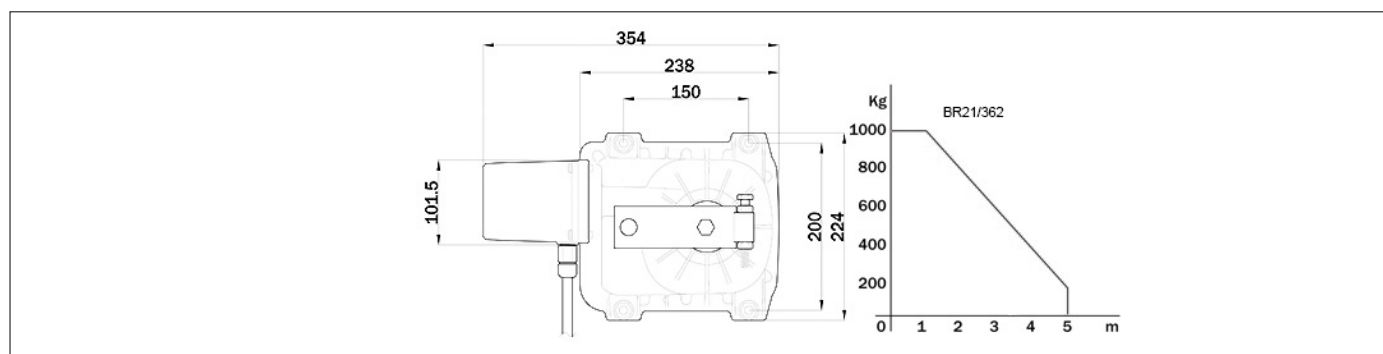

PREDISPOSITION FOR STANDARD INSTALLATION

PRODUCT ACCESSORIES

<p>LT300 Levers group for opening up to 125°.</p>	<p>LT301 Levers group for opening up to 360°.</p>	<p>LT301/R Levers group for opening up to 360°, with reinforced chain.</p>	<p>LT300/90SX Levers group for opening up to 103° - 90° turned - left.</p>	<p>LT300/90DX Levers group for opening up to 103° - 90° turned - right.</p>	<p>LT327/SC Pinion gear ¾ Z13 of adaptation in pinion combining ¾ Z16.</p>
<p>RL650/R Release system for underground motor with standard lever, reinforced steel version.</p>	<p>RL651 Release system for underground motor with european cylinder key (DIN).</p>	<p>RL663 Long release lever for underground motor.</p>			